

# Granny Flat and Timber Cabin

# PRICE LIST

Pricing as of 1st of November, 2013



## What's Inside

Size 1 – 4m x 3m Granny Flat (12 sqm).....	2
Size 2 – 6m x 3m Granny Flat (18 sqm).....	3
Size 3 – 5m x 4m Granny Flat (20 sqm).....	4
Size 4 – 6m x 4m Granny Flat (24 sqm).....	5
Size 5 – 9m x 3m Granny Flat (27 sqm).....	6
Size 6 – 5m x 6m Granny Flat (30 sqm).....	7
Size 7 – 8m x 4m Granny Flat (32 sqm).....	8
Size 8 – 3m x 12m Granny Flat (36 sqm).....	9
Size 9 – 4m x 12m Granny Flat (48 sqm).....	10
Size 10 – 5m x 12m Granny Flat (60sqm).....	11



**Byron Backyard Studios**  
[www.byronbackyard.com.au](http://www.byronbackyard.com.au)

PH (02) 6680 9014  
[info@byronbackyard.com.au](mailto:info@byronbackyard.com.au)

## Size 1: 4.0m x 3.0m Granny Flat (12 sqm)

Your new 4.0m x 3.0m timber cabin or granny flat comes with a range of fantastic options so take your time to find out which one suits you best. It is available in two standard packages that be erected on a concrete slab or with a timber floor.

✓ **Package A:** base unit to go onto concrete slab **\$10,856** including delivery to metro areas (discounted credit card or direct deposit price) or **\$79 per week** over 36 months. Includes:

- Pre-fabricated frame work
- Exterior Weathertex
- Colorbond roof, gutter and downpipes
- Doors as per plan
- Windows as per plan
- Assembly instructions
- 1300 support line

*Please note - internal walls, internal doors, internal lining, kitchen and bathroom not included*

✓ **Package B:** additional sub floor **\$2,831** including delivery to metro areas (discounted credit card or direct deposit price) or **\$21 per week** over 36 months. Includes:

- Sub floor frame
- Yellow tongue flooring
- Standard support kit (low wind rating, good soil)



Optional 1.5m wide x 4.0m long veranda roof and posts **\$1,104** including delivery to metro areas (discounted credit card or direct deposit price) or **\$8 per week** over 36 months.

Optional Veranda 1.5m wide x 4.0m long sub floor and support posts **\$1,635** including delivery to metro areas (discounted credit card or direct deposit price) or **\$12 per week** over 36 months.

*Please note – items such as gyprock lining, internal walls, internal doors, kitchens, furniture, installation, electrical and plumbing not included in pricing, in heavy wind areas and/or poor soil areas you may require steel supports with package B at additional charge (standard 100 x 75 timber support posts included)*

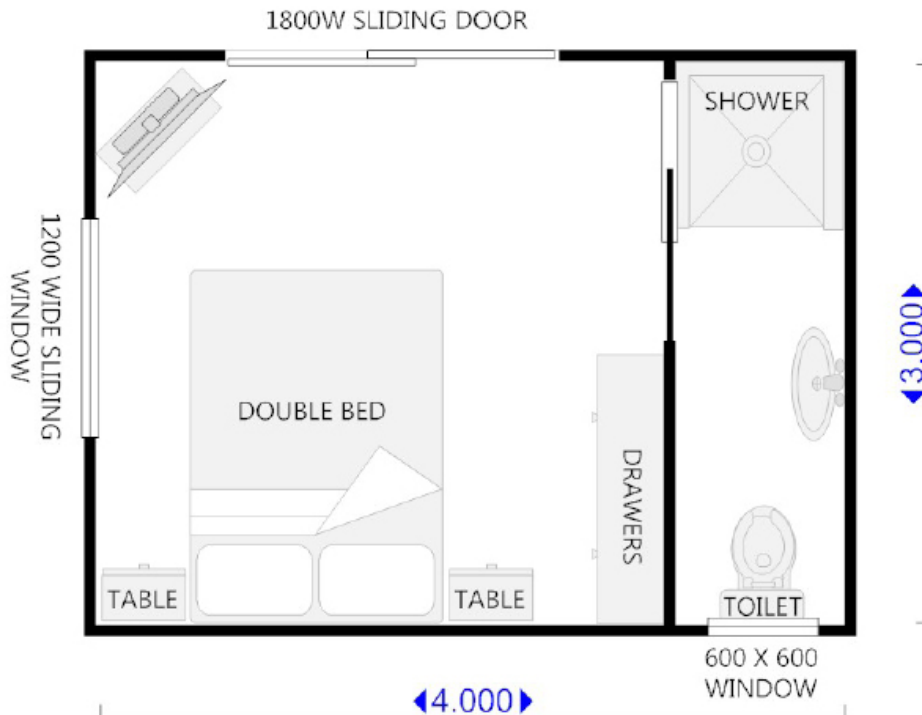

## Size 2: 6.0m x 3.0m Granny Flat (18 sqm)

An all time favourite for extra living or recreational space without moving home. The 6.0m x 3.0m is available in two standard packages that be erected on a concrete slab or with a timber floor.

✓ **Package A:** base unit to go onto concrete slab **\$12,754** including delivery to metro areas (discounted credit card or direct deposit price) or **\$93 per week** over 36 months.s. Includes:

- Pre-fabricated frame work
- Exterior Weathertex
- Colorbond roof, gutter and downpipes
- Doors as per plan
- Windows as per plan
- Assembly instructions
- 1300 support line

*Please note - internal walls, internal doors, internal lining, kitchen and bathroom not included*

✓ **Package B:** additional subfloor **\$3,987** including delivery to metro areas – discounted credit card or direct deposit price or **\$29 per week** over 36 months. Includes:

- Sub floor frame
- Yellow tongue flooring
- Standard support kit (low wind rating, good soil)

Optional 1.50m wide x 6.0m long veranda roof and posts **\$1,914** including delivery to metro areas (discounted credit card or direct deposit price) or **\$14 per week** over 36 months..

Optional Veranda 1.50m wide x 6m long sub floor and support posts **\$2,322** including delivery to metro areas (discounted credit card or direct deposit price) or **\$17 per week** over 36 months.

*Please note – items such as gyprock lining, internal walls, internal doors, kitchens, furniture, installation, electrical and plumbing not included in pricing, in heavy wind areas and/or poor soil areas you may require steel supports with package B at additional charge (standard 100 x 75 timber support posts included)*

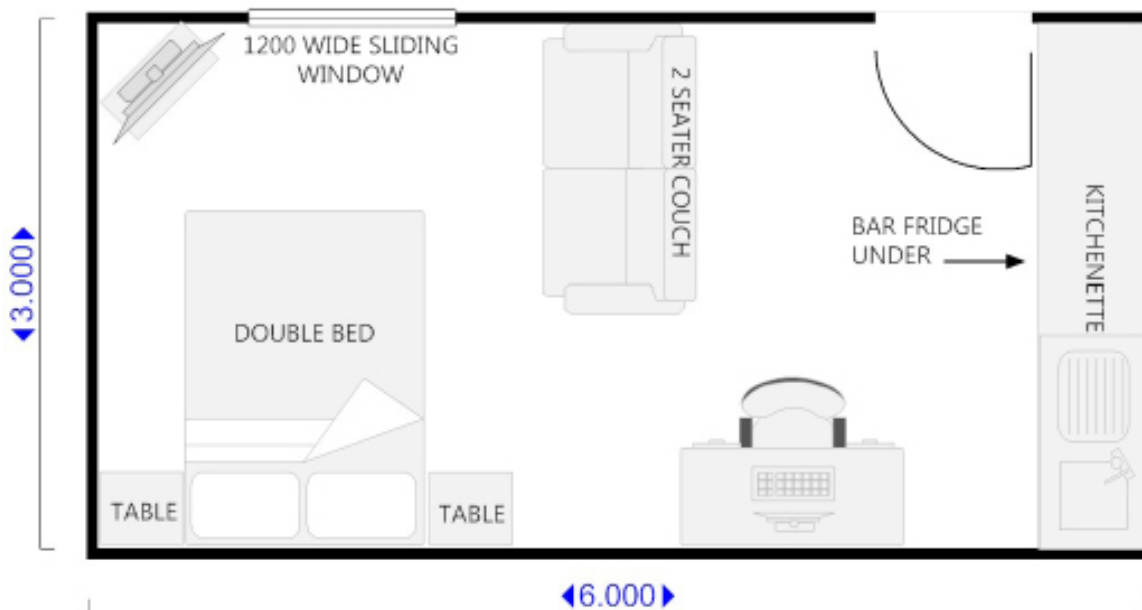

## Size 3: 5.0m x 4.0m Granny Flat (20 sqm)

The perfect backyard retreat, home office, studio and more... Available in two standard packages this granny flat can be erected on a concrete slab or timber decking.

✓ **Package A:** base unit to go onto concrete slab **\$12,868** including delivery to metro areas (discounted credit card or direct deposit price) or **\$94 per week** over 36 months. Includes:

- Pre-fabricated frame work
- Exterior Weathertex
- Colorbond roof, gutter and downpipes
- Doors as per plan
- Windows as per plan
- Assembly instructions
- 1300 support line

*Please note - internal walls, internal doors, internal lining, kitchen and bathroom not included*

✓ **Package B:** additional subfloor **\$4,296** including delivery to metro areas (discounted credit card or direct deposit price) or **\$32 per week** over 36 months. Includes:

- Sub floor frame
- Yellow tongue flooring
- Standard support kit (low wind rating, good soil)



Optional 1.5m wide x 5.0m long veranda roof and posts **\$1,716** including delivery to metro areas (discounted credit card or direct deposit price) or **\$13 per week** over 36 months..

Optional Veranda 1.5m wide x 5 m long sub floor and support posts **\$2,100** including delivery to metro areas (discounted credit card or direct deposit price) or **\$16 per week** over 36 months..

*Please note – items such as gyprock lining, internal walls, internal doors, kitchens, furniture, installation, electrical and plumbing not included in pricing, in heavy wind areas and/or poor soil areas you may require steel supports with package B at additional charge (standard 100 x 75 timber support posts included)*

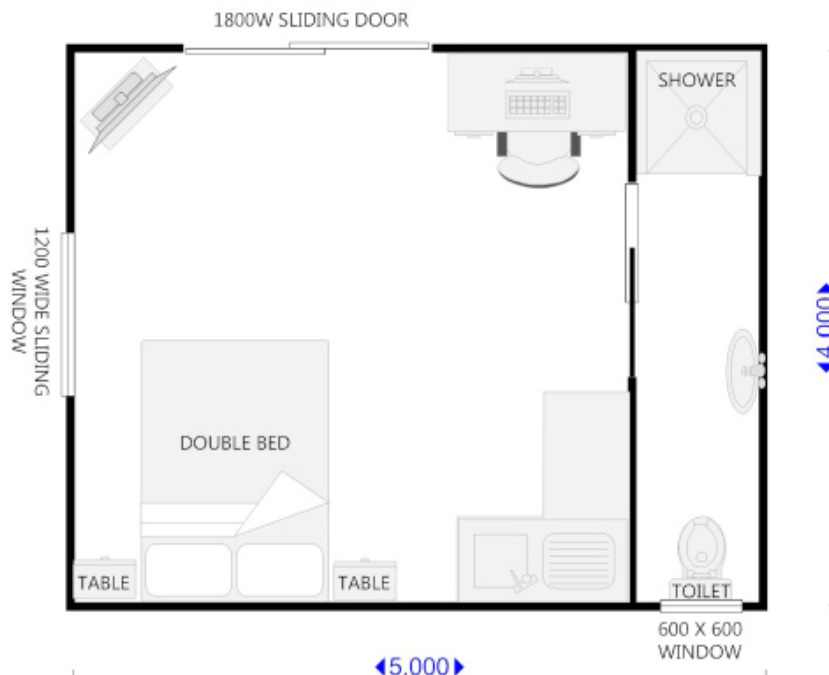

## Size 4: 6.0m x 4.0m Granny Flat (24 sqm)

A proven favourite with homeowners and home businesses; a great granny flat solution which is available in two standard packages that be erected on concrete or timber subfloor.

✓ **Package A:** base unit to go onto concrete slab **\$13,925** including delivery to metro areas (discounted credit card or direct deposit price) or **\$101 per week** over 36 months.. Includes:

- Pre-fabricated frame work
- Exterior Weathertex
- Colorbond roof, gutter and downpipes
- Doors as per plan
- Windows as per plan
- Assembly instructions
- 1300 support line

*Please note - internal walls, internal doors, internal lining, kitchen and bathroom not included*

✓ **Package B:** additional subfloor **\$4,944** including delivery to metro areas (discounted credit card or direct deposit price) or **\$36 per week** over 36 months. Includes:

- Sub floor frame
- Yellow tongue flooring
- Standard support kit (low wind rating, good soil)

Optional 1.5m wide x 6.0m long veranda roof and posts **\$1,914** including delivery to metro areas (discounted credit card or direct deposit price) or **\$14 per week** over 36 months.

Optional Veranda 1.5m wide x 6.0m long sub floor and support posts **\$2,322** including delivery to metro areas (discounted credit card or direct deposit price) or **\$17 per week** over 36 months.

*Please note – items such as gyprock lining, internal walls, internal doors, kitchens, furniture, installation, electrical and plumbing not included in pricing, in heavy wind areas and/or poor soil areas you may require steel supports with package B at additional charge (standard 100 x 75 timber support posts included)*

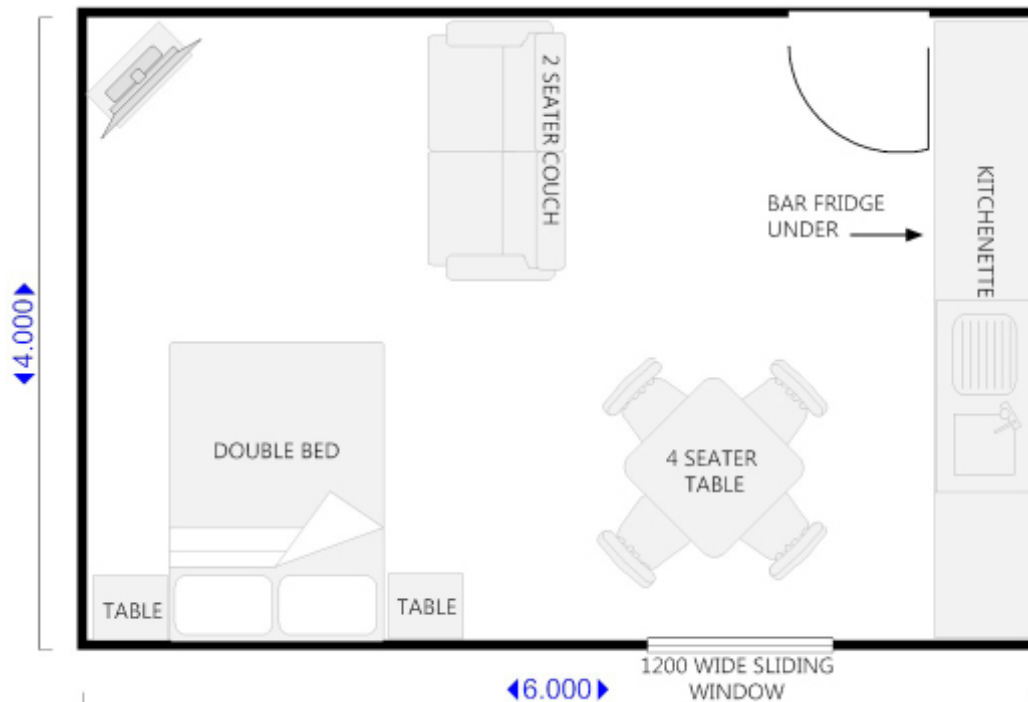

## Size 5: 9.0m x 3.0m Granny Flat (27 sqm)

The residential and commercial problem solver. The 9.0m x 3.0m is available in two standard packages that be erected on a concrete slab or with a timber floor.

✓ **Package A:** base unit to go onto concrete slab **\$15,602** including delivery to metro areas (discounted credit card or direct deposit price) or **\$114 per week** over 36 months. Includes:

- Pre-fabricated frame work
- Exterior Weathertex
- Colorbond roof, gutter and downpipes
- Doors as per plan
- Windows as per plan
- Assembly instructions
- 1300 support line

*Please note - internal walls, internal doors, internal lining, kitchen and bathroom not included*

✓ **Package B:** additional subfloor **\$5,583** including delivery to metro areas (discounted credit card or direct deposit price) or **\$40 per week** over 36 months. Includes:

- Sub floor frame
- Yellow tongue flooring
- Standard support kit (low wind rating, good soil)

Optional 1.5m wide x 9.0m long veranda roof and posts **\$2,102** including delivery to metro areas (discounted credit card or direct deposit price) or **\$16 per week** over 36 months.

Optional Veranda 1.5m wide x 9 m long sub floor and support posts **\$3,382** including delivery to metro areas (discounted credit card or direct deposit price) or **\$25 per week** over 36 months.

*Please note – items such as gyprock lining, internal walls, internal doors, kitchens, furniture, installation, electrical and plumbing not included in pricing, in heavy wind areas and/or poor soil areas you may require steel supports with package B at additional charge (standard 100 x 75 timber support posts included)*

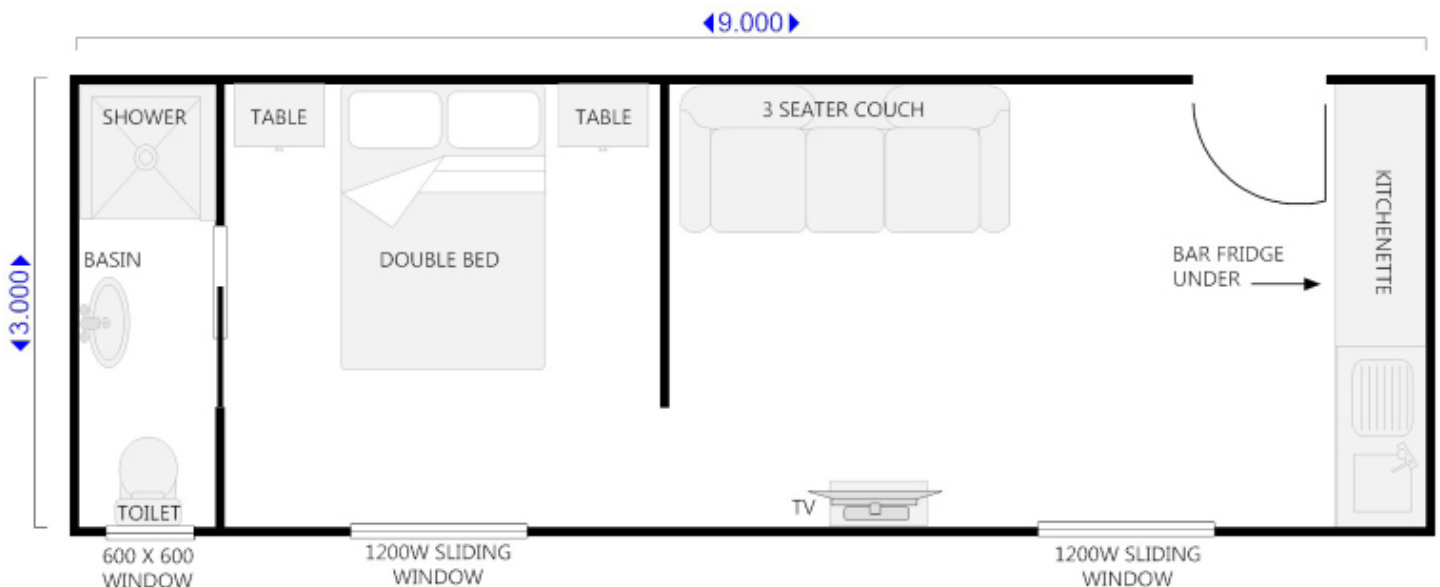

## Size 6: 6.0m x 5.0m Granny Flat (30 sqm)

Great features, comfort, style and price; available in two standard packages this granny flat can be erected on concrete or timber decking.

✓ **Package A:** base unit to go onto concrete slab **\$16,542** including delivery to metro areas (discounted credit card or direct deposit price) or **\$120 per week** over 36 months. Includes:

- Pre-fabricated frame work
- Exterior Weathertex
- Colorbond roof, gutter and downpipes
- Doors as per plan
- Windows as per plan
- Assembly instructions
- 1300 support line

*Please note - internal walls, internal doors, internal lining, kitchen and bathroom not included*

✓ **Package B:** additional subfloor **\$5,709** including delivery to metro areas (discounted credit card or direct deposit price) or **\$42 per week** over 36 months. Includes:

- Sub floor frame
- Yellow tongue flooring
- Standard support kit (low wind rating, good soil)

Optional 1.5m wide x 6.0m long veranda roof and posts **\$1,914** including delivery to metro areas (discounted credit card or direct deposit price) or **\$14 per week** over 36 months.

Optional Veranda 1.5m wide x 6.0m long sub floor and support posts **\$2,322** including delivery to metro areas (discounted credit card or direct deposit price) or **\$17 per week** over 36 months.

*Please note – items such as gyprock lining, internal walls, internal doors, kitchens, furniture, installation, electrical and plumbing not included in pricing, in heavy wind areas and/or poor soil areas you may require steel supports with package B at additional charge (standard 100 x 75 timber support posts included)*

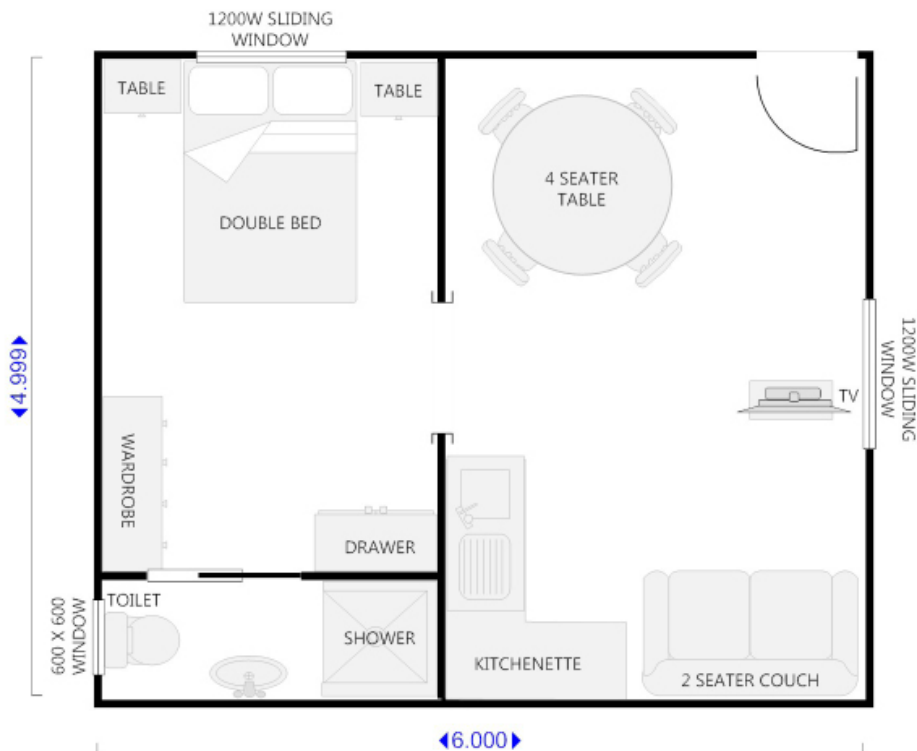

## Size 7: 8.0m x 4.0m Granny Flat (32 sqm)

Solve the living alone worries, rental and renovating costs in one. The 8.0m x 4.0m is available in two standard packages; this granny flat can be erected on concrete or optional timber subfloor.

✓ **Package A:** base unit to go onto concrete slab **\$17,614** including delivery to metro areas (discounted credit card or direct deposit price) or **\$128 per week** over 36 months. Includes:

- Pre-fabricated frame work
- Exterior Weathertex
- Colorbond roof, gutter and downpipes
- Doors as per plan
- Windows as per plan
- Assembly instructions
- 1300 support line

*Please note - internal walls, internal doors, internal lining, kitchen and bathroom not included*

✓ **Package B:** additional subfloor **\$6,218** including delivery to metro areas (discounted credit card or direct deposit price) or **\$46 per week** over 36 months. Includes:

- Sub floor frame
- Yellow tongue flooring
- Standard support kit (low wind rating, good soil)

Optional 1.5m wide x 8.0m long veranda roof and posts **\$2,562** including delivery to metro areas (discounted credit card or direct deposit price) or **\$19 per week** over 36 months.

Optional Veranda 1.5m wide x 8.0m long sub floor and support posts **\$3,034** including delivery to metro areas (discounted credit card or direct deposit price) or **\$22 per week** over 36 months.

*Please note – items such as gyprock lining, internal walls, internal doors, kitchens, furniture, installation, electrical and plumbing not included in pricing, in heavy wind areas and/or poor soil areas you may require steel supports with package B at additional charge (standard 100 x 75 timber support posts included)*

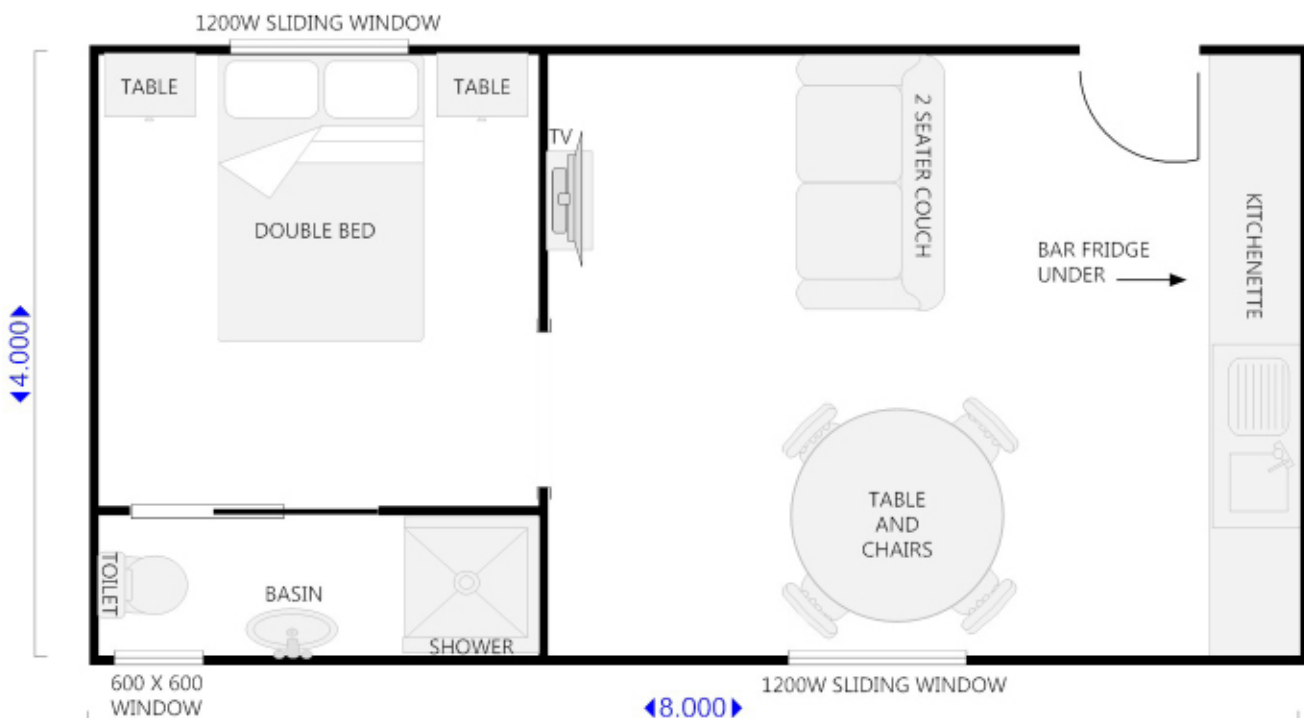



## Size 8: 3.0m x 12.0m Granny Flat (36 sqm)

The twin bedroom is the best in it's class. The 3.0m x 12.0m granny flat is available in two standard packages and can be erected on concrete or timber decking.

✓ **Package A:** base unit to go onto concrete slab **\$19,900** including delivery to metro areas (discounted credit card or direct deposit price) or **\$140 per week** over 36 months. Includes:

- Pre-fabricated frame work
- Exterior Weathertex
- Colorbond roof, gutter and downpipes
- Doors as per plan
- Windows as per plan
- Assembly instructions
- 1300 support line

*Please note - internal walls, internal doors, internal lining, kitchen and bathroom not included*

✓ **Package B:** additional subfloor **\$7,277** including delivery to metro areas (discounted credit card or direct deposit price) or **\$53 per week** over 36 months. Includes:

- Sub floor frame
- Yellow tongue flooring
- Standard support kit (low wind rating, good soil)

Optional 1.5m wide x 12.0m long veranda roof and posts **\$2,700** including delivery to metro areas (discounted credit card or direct deposit price) or **\$20 per week** over 36 months.

Optional Veranda 1.5m wide x 12.0m long sub floor and support posts **\$4,431** including delivery to metro areas (discounted credit card or direct deposit price) or **\$33 per week** over 36 months.

*Please note – items such as gyprock lining, internal walls, internal doors, kitchens, furniture, installation, electrical and plumbing not included in pricing, in heavy wind areas and/or poor soil areas you may require steel supports with package B at additional charge (standard 100 x 75 timber support posts included)*

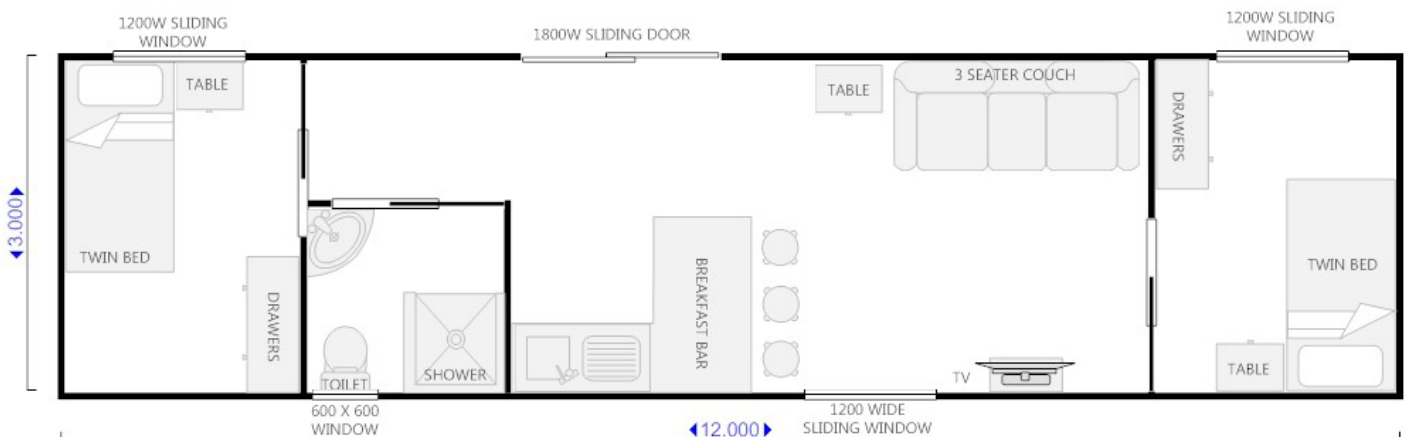

## Size 9: 4.0m x 12.0m Granny Flat (48 sqm)

Charisma and charm at a price you'll appreciate and like all of our granny flats they have more than one use; this quality 4.0m x 12.0m granny flat is much better value than renting a home unit, or buying into a retirement village and is available in two standard packages that can be erected on a concrete slab or optional timber subfloor.

✓ **Package A:** base unit to go onto concrete slab **\$26,598** including delivery to metro areas (discounted credit card or direct deposit price) or **\$193 per week** over 36 months. Includes:

- Pre-fabricated frame work
- Exterior Weathertex
- Colorbond roof, gutter and downpipes
- Doors as per plan
- Windows as per plan
- Assembly instructions
- 1300 support line

*Please note - internal walls, internal doors, internal lining, kitchen and bathroom not included*

✓ **Package B:** additional subfloor **\$9,011** including delivery to metro areas (discounted credit card or direct deposit price) or **\$66 per week** over 36 months. Includes:

- Sub floor frame
- Yellow tongue flooring
- Standard support kit (low wind rating, good soil)

Optional 1.5m wide x 12.0m long veranda roof and posts **\$2,700** including delivery to metro areas (discounted credit card or direct deposit price) or **\$20 per week** over 36 months.

Optional Veranda 1.5m wide x 12 long sub floor and support posts **\$4,431** including delivery to metro areas (discounted credit card or direct deposit price) or **\$33 per week** over 36 months.

*Please note – items such as gyprock lining, internal walls, internal doors, kitchens, furniture, installation, electrical and plumbing not included in pricing, in heavy wind areas and/or poor soil areas you may require steel supports with package B at additional charge (standard 100 x 75 timber support posts included)*

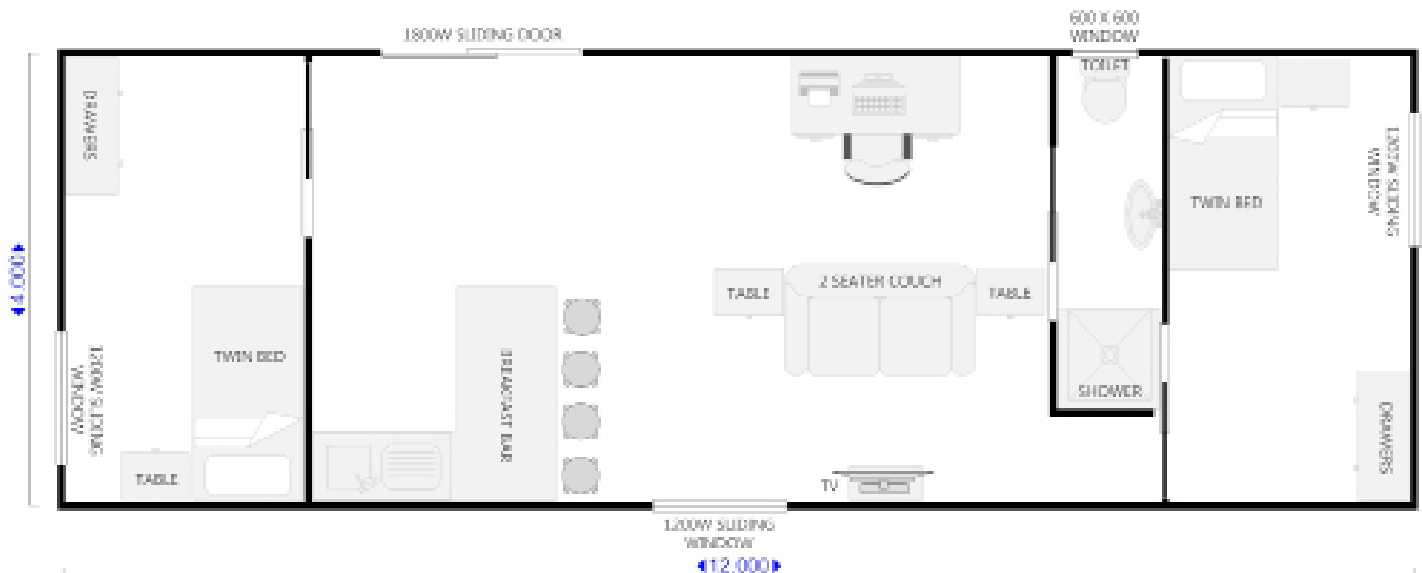

## Size 10: 5.0m x 12.0m Granny Flat (60 sqm)

The 5.0m x 12.0m three bedroom, two bathroom granny flat is the complete package. It is better value than renting a home unit or buying into a retirement village and is available in two standard packages that can be erected on concrete or timber decking.

✓ **Package A:** base unit to go onto concrete slab **\$33,027** including delivery to metro areas (discounted credit card or direct deposit price) or **\$240 per week** over 36 months. Includes:

- Pre-fabricated frame work
- Exterior Weathertex
- Colorbond roof, gutter and downpipes
- Doors as per plan
- Windows as per plan
- Assembly instructions
- 1300 support line

*Please note - internal walls, internal doors, internal lining, kitchen and bathroom not included*

✓ **Package B:** additional subfloor **\$10,787** including delivery to metro areas (discounted credit card or direct deposit price) or **\$79 per week** over 36 months. Includes:

- Sub floor frame
- Yellow tongue flooring
- Standard support kit (low wind rating, good soil)

Optional 1.5m wide x 12.0 long veranda roof and posts **\$2,700** including delivery to metro areas (discounted credit card or direct deposit price) or **\$20 per week** over 36 months.

Optional Veranda 1.5m sub floor and support posts **\$4,431** including delivery to metro areas (discounted credit card or direct deposit price) or **\$33 per week** over 36 months.

*Please note – items such as gyprock lining, internal walls, internal doors, kitchens, furniture, installation, electrical and plumbing not included in pricing, in heavy wind areas and/or poor soil areas you may require steel supports with package B at additional charge (standard 100 x 75 timber support posts included).*





**What Are You Waiting For?  
Extend Your Living Space And Add Value To Your Home  
With A Cost Effective Granny Flat Or Timber Cabin.**



**Byron Backyard Studios**  
[www.byronbackyard.com.au](http://www.byronbackyard.com.au)

**Phone Toll Free:** (02) 6680 9014

**Email:** [info@byronbackyard.com.au](mailto:info@byronbackyard.com.au)

**Website:** [www.byronbackyard.com.au](http://www.byronbackyard.com.au)